**Spare Parts****Page**

Clamping Elements for Cutter Heads and
Shank-Type Tools with Turnover Knives
Screw Torques

1

Screws / Setscrews

10

Nuts

17

Spacers

18

Reducing Bushings / Reducing Rings

23

Ball Bearings

29

Auxiliary Tools

31

Clamping Element

925.100

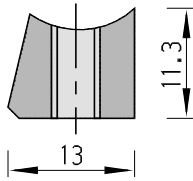

For LEUCO cutter heads with single wedge and wedge/counter wedge clamping

- hardened; ensures long life

B mm	Ident-No.
6,8	010750
18	003100
26	003101
46	003103

Clamping Element

925.100

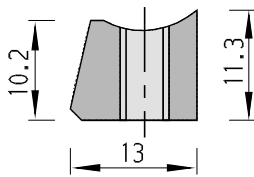

For LEUCO cutter heads with single wedge and wedge/counter wedge clamping

- hardened; ensures long life

B mm	Ident-No.
9	163411

Clamping Element

925.100

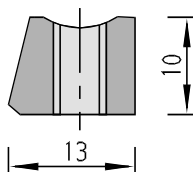

For LEUCO cutter heads with single wedge and wedge/counter wedge clamping

- hardened; ensures long life

	B mm	Ident-No.
15 degree, R + L	26	050821 #

Counter Clamping Element

925.200

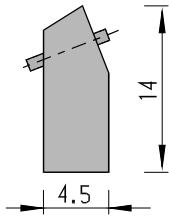

For LEUCO cutter heads with wedge/counter wedge clamping

- hardened; ensures long life

B mm	Ident-No.
6,8	010751
10	003090
18	003091
28	003092
48	003094

Counter Clamping Element

925.200

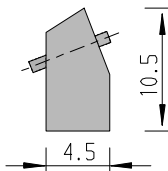

For LEUCO cutter heads with wedge/counter wedge clamping

- hardened; ensures long life

B mm	Ident-No.
10	003108 #

Counter Clamping Element

925.200

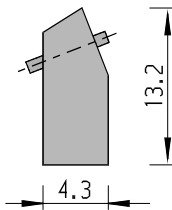

For LEUCO cutter heads with wedge/counter wedge clamping

- hardened; ensures long life

B mm	Ident-No.
9	163410

Clamping Strip

925.300

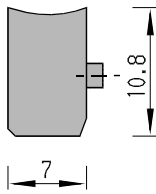

For LEUCO cutter heads with clamping strip

- hardened; ensures long life

	B mm	Ident-No.
	15,6	163488
	18	163077
	27,6	163078

Clamping Strip

925.300

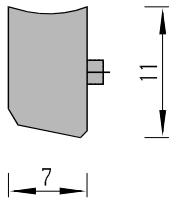

For LEUCO cutter heads with clamping strip

- hardened; ensures long life

	B mm	Ident-No.
	7,2	168074
	8	167255
radius 3 mm	10	168344
	10	164526
groove & chamfer	17	167971
	18	164076
groove & chamfer	26,6	167885
Chamfer 15 degree	27,5	164185
	39	164077
	48	166984
	58	167144

Clamping Strip

925.300

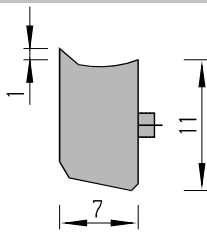

For LEUCO cutter heads with clamping strip

- hardened; ensures long life

	B mm	Ident-No.
	10	171221

Clamping Strip

925.300

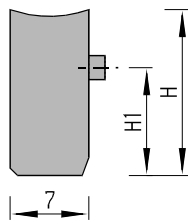

For LEUCO cutter heads with clamping strip

- hardened; ensures long life

B mm	H mm	H1 mm	Ident-No.
10	12	7,4	162106
12	12,6	9	162095
15	16	9,5	162107
19	16	11,5	162100
19	18	10,5	162108
25	18	13	162104

Clamping Strip

925.300

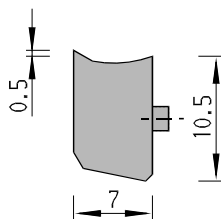

For LEUCO cutter heads with clamping strip

- hardened; ensures long life

B mm	Ident-No.
15,6	169246

Clamping Strip for Swivel Cutter Head & Shank-Type Swivel Cutter

925.300

Ident-No.		
6x10,5x38	172272	
for swivel cutter head	6x10,5x48,5	166505

Clamping Strip with Profile

925.300

	Ident-No.
6x9,5x12	170342
7x14,5x24	170262
7x15,5x18	168358
7x15,5x18	168357

Clamping Strip for Super Profiler

925.300

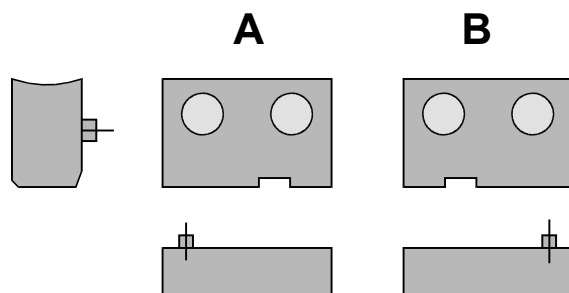

Clamping Element for Shank-Type Tool

925.500

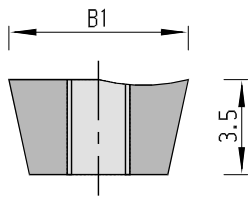

clamping element for shank-type tools

- hardened; ensures long life

B mm	B1 mm	Ident-No.
48	9	167867
48	9	168889

Clamping Element for Shank-Type Tool

925.500

pour plaq. =	B mm	pour Ø D mm	Ident-No.
	20	8 R	169276 o
	20	8 R / 9.52 R	175722 o
	20	10 R	169277 o
	25	10 R	175724 o
	20	12 R	169278 o
	30	12 L	175730 o
	30	12 R	175726 o
	30	14 R	169279 o
	30	14 L	175731 o
	30	14 R	175728 o
	30	16 R	169280 o
	50	16 R	171111 o
	50	16 R	175729 o
	30	16 L	171117 o
	30	18 R	169281 o
	50	18 R	171113 o
	50	18 L	171114 o
	30	18 L	171118 o
	30	20 R	169282 o
	50	20 R	171115 o
	30	20 L	171119 o
	30	22 R	169283 o

Hex socket setscrew (DIN 913...916)

Thread	Width across flats (mm)	Tightening moment MA (Nm) for property class 45H
M3	1.5	0.82
M4	2.0	1.90
M5	2.5	3.50
M6	3.0	5.50
M8	4.0	9.50
M10	5.0	14.30

Hex socket cap screw (DIN 912)

Thread	Width across flats (mm)	Tightening moment MA (Nm) for property class 8.8
M3	2.5	1.1
M4	3.0	2.5
M5	4.0	5.0
M6	5.0	8.4
M8	6.0	15.0
M10	8.0	15.0

Screw with inner torx

Thread	Torx-Size	Tightening moment MA (Nm) for property class	
		10.9	12.9
M2.5	T8		1.31
M3	T9		2.30
M3.5	T15	2.95	
M4	T15		5.20
M4x0.5	T9		2.00
M4.5	T15		4.00
M5	T20	8.60	
M6	T25		15.00

Setscrew

995.161

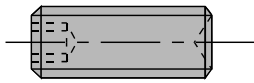

Hex socket setscrew with circular cutting edge

	Ident-Nr.
DIN 916 M5x4	001608
DIN 916 M5x5	001609
DIN 916 M6x4	167068
DIN 916 M6x6	180003
DIN 916 M6x5	165049

Setscrew

995.161

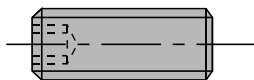

Hex socket setscrew

	Ident-Nr.
DIN 913 M5x10	180028
DIN 913 M6x6 self-locking (TUFLOK)	163546
DIN 913 M6x8	180036
DIN 913 M8x10 self-locking (TUFLOK)	059549

Setscrew

995.161

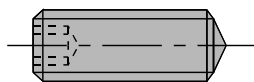

Hex socket setscrew with cone point

	Ident-Nr.
DIN 914 M5x10	001686

Setscrew

995.161

Hex socket setscrew with dog point

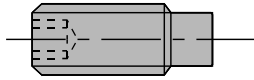

	Ident-Nr.
DIN 915 M5x8	180015
DIN 915 M5x12	050565
DIN 915 M6x6	163841
DIN 915 M6x10	180002
DIN 915 M6x12	180214
DIN 915 M6x16	001617
DIN 915 M6x25	167979
DIN 915 M8x10	001622
DIN 915 M8x12	180001
DIN 915 M8x14	168453
DIN 915 M8x16	164422
DIN 915 M8x20	001625
DIN 915 M8x35	165937
DIN 915 M10x12	001630
DIN 915 M10x16	168192
DIN 915 M10x25	168108
DIN 915 M12x25	181466

Hex Socket Setscrew

995.161

	Ident-Nr.
M8x20	168874 o

Setscrew

995.162

Slotted setscrew

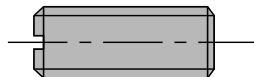

	Ident-Nr.
ISO 4766 M5x10	ISO 4766 001600



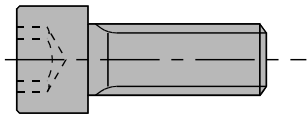

Hex socket cap screw

	Ident-No.
DIN 912 M5x40	001875
DIN 912 M6x16	001879
DIN 912 M6x40	001884
DIN 912 M8x10	001890 o
DIN 912 M12x30	001917
DIN 912 M12x50	001921
DIN 912 M16x40	001933
DIN 912 M16x50	166442
DIN 912 M16x50 LH	166431
DIN 912 M16x70	059169
DIN 912 M16x120	001938
DIN 912 M20x40	059166 o
DIN 912 M20x50	166441
DIN 912 M20x50 LH	166440
DIN 912 M20x80	056178 #
DIN 912 M20x120	056153

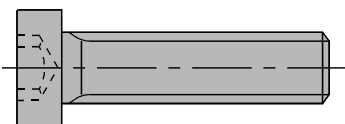

Hex socket cap screw

	Ident-No.
DIN 7984 M5x16	165961
DIN 7984 M8x16	180004
DIN 7984 M8x30	180005
DIN 7984 M8x50	180006

Cap Screw with Torx

995.115

Cap screw with Torx

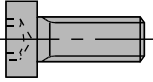

	Ø D mm	Ident-No.
M2,5x3 T8	3,45	168237
M2,5x4 T8	3,45	168238
M3x5,5 T8	4,35	168239
M3x10 T8	4,4	168782
M3,5x3,8 T15	7	162645
M3,5x5,5 T15	6	168236
M3,5x6,5 T15	6,2	163223
M3,5x6,5 T15	7	162644
M3,5x8 T15	6,25	163222
M3,5x11,5 T15	6,25	163221 #
M5x12 T20	8,5	171237

Countersink Screw

995.122

Slotted countersink screw

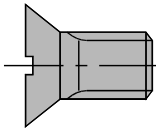

	Ident-No.
DIN 963 M5x10	055881
DIN 87 M5x12	180007

Countersink Screw with Torx

995.125

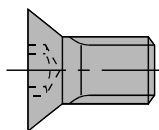

Countersink screw with Torx

			Ident-No.
M2,5x5,5	T8		167486
M3x7,3	T8		166502
M3,5x5,5	T15		162649
M3,5x6	T15		162648
M4x0,5x3,2	T9		163925
M4x0,5x4,2	T9		165908
M4x0,5x5,3	T9		170202
M5x6	T20	for Rapido	176199
M5x6,8	T15		180839
M5x8	T20	head Ø 10	164005
M5x9	T20	head Ø 9 for Ledinek Rotoles	827277
M5x10	T20	head Ø 10	171236
M5x10,8	T15		180840
M5x12	T20	head Ø 9.3	166709
M5x13,5	T20	head Ø 6.3	171238
M5x16	T20		164839
M6x10	T20	for Camfer. Cutter Head	181244

Tapered Screw with Torx

995.195

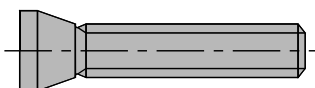

			Ident-No.
M5x15,5	T20	head Ø 7	173492
M6x17,5	T25	head Ø 9	173490

Cutter Retaining Bolt

995.190

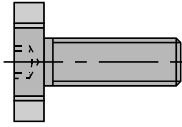

Hex socket cutter retaining bolt

	Ident-No.
M16x26xØ42	173592
M12x22xØ35	173591
Ø20xM8x23	171393
Ø28xM10x26	171392

Stop Screw

995.190

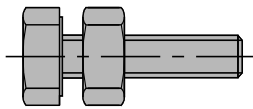

Stop screw for shank-type tools

	Ident-No.
M6x16 for shank type Ø 16	172797
M8x25 for shank type Ø 25	172828

Special Screw PS-System / PS 2000 E

995.190

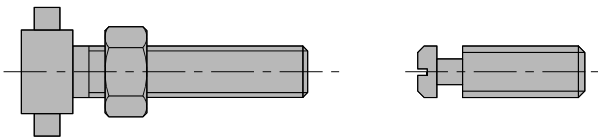

PS-System

PS 2000-E

	Ident-No.
M6x20 for PS-System 16 mm	172115
M8x25 for PS-System 25 mm	172113
M8x19 for PS 2000-E	172921

Setscrew for Super Profiler

995.191

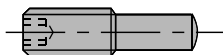

Special hex socket setscrew for BG-Test super profiler

	Ident-No.
M8x24	167269

Screw for "Klack" Bottom Part

995.191

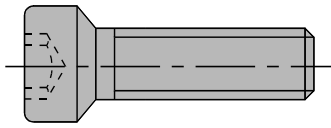

Special screw for "Klack" bottom part

	Ident-No.
M8x24 LH	180013
M8x24 RH	180012

Countersink Screw with Collar

995.192

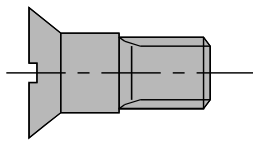

	Ident-No.
M5x12	180009

Countersink Screw for Segments

995.192

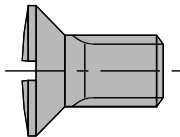

	Ident-No.
M8x12,5	180010
M8x17	180011

Round Head Screw with Torx

995.195

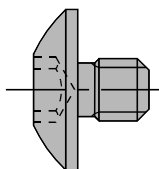

	Ident-No.
M3,5x4 T15	head Ø 9 168893
M3,5x12 T15	head Ø 9 171067
M4x5,9 T15	head Ø 9 167966

Hex Nut

995.210

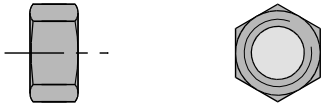

Hex Nut

	Ident-No.
DIN 934 M4	009631
DIN 934 M6	009633

Nut for Turnover Knife

995.290

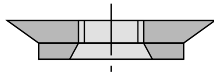

Special nut for groover turnover knives

	Ident-No.
M4x0,5x1,6	163704
M 4x0,5x2,2	163703
M 4x0.5x2.75	165907
M4x0,5x4,1	170203

Union Nut

995.290

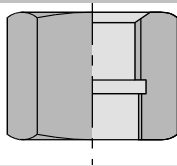

Union nut for MK shanks

	Ident-No.
M33x3/M30x1,5/double edged	170275 o
W 1 1/8"/W20x14/hex	167911 o
W 1 1/8"/M30x1,5/LH/hex	167780
W 1 1/8"/M30x1,5/hex	165561

Lock nut

995.290

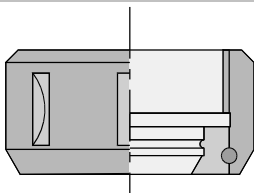

lock nut for draw-in collet chuck

	Ident-No.
M30x1,5 RH ball-bearing	178763
M40x1,5 RH with sleeve bearing	178761
M48x2 RH with sleeve bearing	178764
M50x1,5 RH with sleeve bearing	178762 o

Ø D mm	B mm	Ø d mm	DKN	NL	Ident-No.
14	0,1	6			176422 o
14	0,2	6			176423 o
14	0,5	6			176424 o
14	1	6			176425 o
14	2	6			176426 o
14	5	6			176427 o
40	0,1	20			000218
40	0,2	20			000219
40	0,5	20			000220
40	1	20			000221
40	2	20			000222
40	3	20			000223
80	0,05	22		2/4/42	017424
80	0,1	22		2/4/42	017425
80	0,2	22		2/4/42	017426
45	0,1	25			000230
45	0,2	25			000231
45	0,5	25			000232
45	1	25			000233
45	2	25			000234
45	3	25			000235
50	0,1	30			000242
50	0,2	30			000243
50	0,5	30			000244
50	1	30			000245
50	2	30			000246
50	3	30			000247
66	0,1	30			000266
66	0,1	30	8x3,3		176700
66	0,2	30			000267
66	0,2	30	8x3,3		176701
66	0,5	30			000268
66	0,5	30	8x3,3		176702
66	1	30			000269
66	1	30	8x3,3		176703
66	2	30			000270
66	2	30	8x3,3		176704
66	3	30			000271
66	3	30	8x3,3		176705
66	4	30			161999

\varnothing D mm	B mm	\varnothing d mm	DKN	NL	Ident-No.
66	4	30	8x3,3		176706
66	10	30			162002
66	10	30	8x3,3		176707
90	0,1	30			000308
90	0,2	30			000309
90	0,5	30			000310
90	1	30			000311
90	2	30			000312
90	3	30			000313
100	0,1	30			000320
100	0,2	30			000321
100	0,5	30			000322
100	1	30			000323
100	2	30			000324
100	3	30			000325
175	0,1	30			000458
175	0,2	30			000459
175	0,5	30			000460
175	1	30			000461
70	0,1	35			000296
70	0,1	35	10x3,3		176436
70	0,2	35			000297
70	0,2	35	10x3,3		176437
70	0,5	35			000298
70	0,5	35	10x3,3		176438
70	1	35			000299
70	1	35	10x3,3		176439
70	2	35			000300
70	2	35	10x3,3		176440
70	3	35			000301
70	3	35	10x3,3		176441
70	4	35			162000
70	4	35	10x3,3		176442
70	10	35			162003
70	10	35	10x3,3		176443
100	0,1	35			000326
100	0,2	35			000327
100	0,5	35			000328
100	1	35			000329
100	2	35			000330
100	3	35			000331
70	0,1	40			000302
70	0,1	40	12x3,3		176444

Ø D mm	B mm	Ø d mm	DKN	NL	Ident-No.
70	0,2	40			000303
70	0,2	40	12x3,3		176445
70	0,5	40			000304
70	0,5	40	12x3,3		176446
70	1	40			000305
70	1	40	12x3,3		176447
70	2	40			000306
70	2	40	12x3,3		176448
70	3	40			000307
70	3	40	12x3,3		176449
70	4	40			162001
70	4	40	12x3,3		176450
70	10	40			162004
70	10	40	12x3,3		176451
120	0,1	40			000344
120	0,2	40			000345
120	0,5	40			000346
120	1	40			000347
120	2	40			000348
90	0,1	50			000314
90	0,2	50			000315
90	0,5	50			000316
90	1	50			000317
90	2	50			000318
90	3	50			000319
100	0,05	50		4/9/80	177019
100	0,1	50		4/9/80	176835
100	0,2	50		4/9/80	176836
100	0,5	50		4/9/80	176837
100	1	50		4/9/80	176838
100	2	50		4/9/80	176839
100	3	50		4/9/80	176840
90	0,05	60		3/9/74	177022
90	0,1	60		3/9/74	177023
90	0,2	60		3/9/74	177024
90	0,5	60		3/9/74	177025
90	1	60		3/9/74	177026
90	2	60		3/9/74	177027
100	0,1	60			000332
100	0,2	60			000333
100	0,5	60			000334
100	1	60			000335
100	2	60			000336

Ø D mm	B mm	Ø d mm	DKN	NL	Ident-No.
100	3	60			000337
120	0,1	60		4/9/100	176830
120	0,15	60		4/9/100	177018
120	0,2	60		4/9/100	176831
120	0,5	60		4/9/100	176832
120	1	60		4/9/100	176495
120	2	60		4/9/100	176833
120	3	60		4/9/100	176834
160	0,1	60			000452
160	0,2	60			000453
160	0,5	60			000454
160	1	60			000455
160	2	60			000456
160	3	60			000457
115	1	80			009255
120	0,1	80		4/9/100+2/6,5/90	177380
120	0,2	80		4/9/100+2/6,5/90	177381
120	0,5	80		4/9/100+2/6,5/90	177382
120	1	80		4/9/100+2/6,5/90	177383
120	2	80		4/9/100+2/6,5/90	177384
120	3	80		4/9/100+2/6,5/90	177385
130	0,5	80			000450
145	0,1	80		4/12/100+4/9/120	552104
145	0,2	80		4/12/100+4/9/120	552105
145	0,5	80		4/12/100+4/9/120	552106
145	1	80		4/12/100+4/9/120	552107

Spacer Set

955.521

Precision spacer set

- 9 piece set consists of:
- 1 piece .1 mm
- 2 piece .2 mm
- 1 piece .5 mm
- 3 piece 1.0 mm
- 1 piece 4.0 mm
- 1 piece 10 mm

Ø D mm	B mm	Ø d mm	Ident-No.
66	18	30	161797
70	18	35	161798
70	18	40	161799

Spacing Collar Set

955.521

Spacing collar set

- 8 piece set consists of:
- 2 piece 5 mm
- 1 piece 8 mm
- 1 piece 10 mm
- 2 piece 16 mm
- 1 piece 25 mm
- 1 piece 40 mm

Ø D mm	B mm	Ø d mm	Ident-No.
50	125	30	160233
60	125	40	160234

Shim for Quick-Release-System

995.520

for Homag machine

Ø D mm	B mm	Ø d mm	DKN	Ident-No.
60	11	35	10x3,3	180647



Reducing bushing for circular saw blades

- to reduce the saw blade bore
- rotation of the clamping flanges must be observed to ensure secure clamping of the tool

Ø D mm	B mm	Ø d mm	Ø d pce	Ident-No.
20	1,6	12,7	1/2"	161946
20	1,6	16		161945
22	2	20		161887
22	4	20		161830
25	2,2	20		000104
30	1,4	15		000107
30	1,4	16		000111
30	1,4	20		000117
30	1,4	25		000125
30	1,8	15,1	19/32"	161949
30	1,9	16		000112
30	1,9	20		000118
30	2	20		016848
30	2	25		000127
30	2,2	15,88	5/8"	000110
30	2,2	16		000113
30	2,2	18		000114
30	2,2	20		000119
30	2,2	22		000120
30	2,2	25		000128
30	2,2	25,4	1"	000130
30	2,2	28		000132
30	3	25		000129
32	2	16		161886
32	2,2	16		000134
32	2,2	20		000135
32	2,2	22		010571
32	2,2	30		000137
35	1	30		000145
35	1,4	30		000146
35	1,9	30		000147
35	2,2	20		000138

35	2,2	24	000139
35	2,2	25	000142
35	2,2	28	000144 s
35	2,2	30	000148
35	2,2	32	000150 s
40	2	32	161962
40	2,2	20	000151
40	2,2	30	000153
40	2,2	35	000154
45	2,5	30	161831
50	2,2	30	000156
55	2,2	30	000159
60	2,2	30	000161
60	2,2	35	000162
60	2,2	40	000163
60	2,2	50	000164
60	2,8	30	010577
70	2,2	30	000166
80	2,2	30	000171
80	2,2	35	000172
80	2,2	50	000175
80	2,2	60	000177
80	2,2	70	000179
80	2,8	60	000178

Reducing bushing

• bore tolerance H7

Ø D mm	B mm	Ø d mm	Ø d pce	Ident-No.
30	5,1 - 10		1"	000416 o
30	5,1 - 10	20		000411 s
30	5,1 - 10	25		000415 &
30	10,1 - 25		1"	000446 o
30	10,1 - 25	20		000441 o
30	10,1 - 25	25		000445 &
30	15,1 - 20		1"	000726 &
30	15,1 - 20	20		000721 o
30	15,1 - 20	25		000725 &
30	20,1 - 25		1"	000756 o
30	20,1 - 25	20		000751 o
30	20,1 - 25	25		000755 &
30	25,1 - 30		1"	000786 &
30	25,1 - 30	20		000781 o
30	25,1 - 30	25		000785 &
30	30,1 - 40		1"	000816 &
30	30,1 - 40	20		000811 &
30	30,1 - 40	25		000815 &
30	40,1 - 50		1"	000846 &
30	40,1 - 50	20		000841 o
30	40,1 - 50	25		000845 o
30	50,1 - 60		1"	000876 o
30	50,1 - 60	20		000871 o
30	50,1 - 60	25		000875 &
30	60,1 - 80		1"	000365
30	60,1 - 80	20		000360
30	60,1 - 80	25		000364
35	5,1 - 10		1 1/4"	000425 o
35	5,1 - 10	20		000420 &
35	5,1 - 10	30		000424 &
35	10,1 - 25		1 1/4"	000705 o
35	10,1 - 25	20		000700 o
35	10,1 - 25	30		000704 &
35	15,1 - 20		1 1/4"	000735 &

35	15,1 - 20	20		000730 o
35	15,1 - 20	30		000734 &
35	20,1 - 25		1 1/4"	000765 &
35	20,1 - 25	20		000760 o
35	20,1 - 25	30		000764 &
35	25,1 - 30		1 1/4"	000795 o
35	25,1 - 30	20		000790 o
35	25,1 - 30	30		000794 &
35	30,1 - 40		1 1/4"	000825 &
35	30,1 - 40	20		000820 o
35	30,1 - 40	30		000824
35	40,1 - 50		1 1/4"	000855 o
35	40,1 - 50	20		000850 o
35	40,1 - 50	30		000854 &
35	50,1 - 60		1 1/4"	000885 &
35	50,1 - 60	20		000880 o
35	50,1 - 60	30		000884 &
35	60,1 - 80		1 1/4"	000374
35	60,1 - 80	20		000369
35	60,1 - 80	30		000373
40	5,1 - 10	20		000428 &
40	5,1 - 10	25		000429 &
40	5,1 - 10	30		000430 &
40	5,1 - 10	35		000891 &
40	10,1 - 25	20		000708 &
40	10,1 - 25	25		000709 o
40	10,1 - 25	30		000710 &
40	10,1 - 25	35		000912 &
40	15,1 - 20	20		000738 o
40	15,1 - 20	25		000739 o
40	15,1 - 20	30		000740 &
40	15,1 - 20	35		000933 &
40	20,1 - 25	20		000768 o
40	20,1 - 25	25		000769 &
40	20,1 - 25	30		000770 &
40	20,1 - 25	35		000954 o
40	25,1 - 30	20		000798 o
40	25,1 - 30	25		000799 o
40	25,1 - 30	30		000800 &
40	25,1 - 30	35		000975 o
40	30,1 - 40	20		000828 &
40	30,1 - 40	25		000829 &
40	30,1 - 40	30		000830 &
40	30,1 - 40	35		000996 &

40	40,1 - 50	20	000858 o
40	40,1 - 50	25	000859 o
40	40,1 - 50	30	000860 &
40	40,1 - 50	35	001017 &
40	50,1 - 60	20	000888 o
40	50,1 - 60	25	000889 o
40	50,1 - 60	30	000890 &
40	50,1 - 60	35	001038 &
40	60,1 - 80	20	000377
40	60,1 - 80	25	000378
40	60,1 - 80	30	000379
40	60,1 - 80	35	000380
60	5,1 - 10	30	000899 &
60	5,1 - 10	35	000900 &
60	5,1 - 10	40	000901 &
60	10,1 - 25	30	000920 &
60	10,1 - 25	35	000921 &
60	10,1 - 25	40	000922 &
60	15,1 - 20	30	000941 &
60	15,1 - 20	35	000942 &
60	15,1 - 20	40	000943 &
60	20,1 - 25	30	000962 &
60	20,1 - 25	35	000963 &
60	20,1 - 25	40	000964 o
60	25,1 - 30	30	000983 &
60	25,1 - 30	35	000984 &
60	25,1 - 30	40	000985 &
60	30,1 - 40	30	001004 &
60	30,1 - 40	35	001005 &
60	30,1 - 40	40	001006 &
60	40,1 - 50	30	001025 &
60	40,1 - 50	35	001026 &
60	40,1 - 50	40	001027 &
60	50,1 - 60	30	001046 o
60	50,1 - 60	35	001047 &
60	50,1 - 60	40	001048 &
60	60,1 - 80	30	000388
60	60,1 - 80	35	000389
60	60,1 - 80	40	000390
80	5,1 - 10	30	000905 &
80	5,1 - 10	35	000906 &
80	5,1 - 10	40	000907 &
80	10,1 - 25	30	000926 &
80	10,1 - 25	35	000927 &

LEUCO Reducing Bushings

80	10,1 - 25	40	000928 &
80	15,1 - 20	30	000947 &
80	15,1 - 20	35	000948 &
80	15,1 - 20	40	000949 &
80	20,1 - 25	30	000968 o
80	20,1 - 25	35	000969 &
80	20,1 - 25	40	000970 &
80	25,1 - 30	30	000989 &
80	25,1 - 30	35	000990 &
80	25,1 - 30	40	000991 o
80	30,1 - 40	30	001010 o
80	30,1 - 40	35	001011 &
80	30,1 - 40	40	001012 &
80	40,1 - 50	30	001031 &
80	40,1 - 50	35	001032 &
80	40,1 - 50	40	001033 &
80	50,1 - 60	30	001052 o
80	50,1 - 60	35	001053 &
80	50,1 - 60	40	001054 o
80	60,1 - 80	30	000394
80	60,1 - 80	35	000395
80	60,1 - 80	40	000396

Reducing Bushing with Collar

956.506

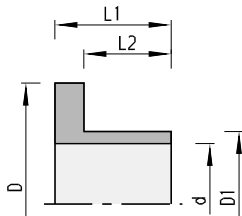

Reducing bushing with collar

Ø D mm	Ø D1 mm	Ø d mm	L1 mm	L2 mm	Ident-No.
55	35	30	24	18	168062 #
60	40	30	24	18	168063
60	40	35	24	18	168064 #



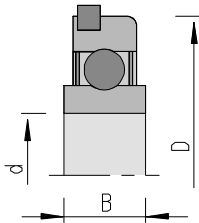

Ball bearing bushing

- application with ball bearing rub collar
- bearing cage sealed against dust
- stop collar for ball bearing ring

$\varnothing D$ mm	B mm	$\varnothing d$ mm	Ident-No.
62	16	30	003578
72	20	40	160203

		Ident-No.
ball bearing thrust ring assy.	$\varnothing 12$	167923
ball bearing thrust ring assy.	$\varnothing 14$	169314
ball bearing	12,7x5x4,76	164920
ball bearing	13x5x6	170265 o
ball bearing	15,9x5x6,35	164921
ball bearing	19x6x6	164922
ball bearing	22x7,5x8	180838
ball bearing with thrust ring	19x7,5x6,35	164229
ball bearing with thrust ring	21x7,5x6,35	170774 o
ball bearing with thrust ring	22x7,5x6,35	164228

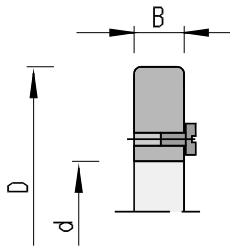

Rub collar

- application on ball bearing bushing
- intermediate dimensions available upon request
- screw for axial locking:
cap screw M4x10 DIN 84
Ident # 001730

$\varnothing D$ mm	B mm	$\varnothing d$ mm	Ident-No.
75	10	62	160205
80	10	62	160206
85	10	62	160207
90	10	62	160208
95	10	62	160209
100	10	62	160210
105	10	62	160211
110	10	62	160212
115	10	62	160213 o
120	10	62	160214
125	10	62	056840
130	10	62	160215 o
135	10	62	160216 o
140	10	62	160217 o
145	10	62	160218 o
150	10	62	160219

Double-End Box Wrench 985.720

	Ident-No.
DIN 3118 9x11	168672 o
DIN 3118 11x13	168670 o
DIN 3118 14x17	168671

Double Open-End Wrench 985.720

	Ident-No.
DIN 895 SW 10/13	171060 o

Open-End Wrench 985.720

	Ident-No.
DIN 902 SW 27	169295 o
DIN 894 SW 36	169296
DIN 894 SW 41	169297
SW 55	058424 o
DIN 902 SW 46x10 breit	178760

Spanner Wrench 985.720

	Ident-No.
DIN 1810 40/42	169298
DIN 1810 45/50	175851
DIN 1810 58/62	169299



Hex Screwdriver

985.730

	Ident-No.
DIN 911 SW 2	009670
DIN 911 SW 2,5	009671
DIN 911 SW 3	009672
DIN 911 SW 4	009673
DIN 911 SW 5	009674
DIN 911 SW 6	009675
DIN 911 SW 8	009677

Hex Screwdriver with Sliding Handle

985.730

	Ident-No.
SW 2,5x100	168010
SW 3x100	166090
SW 4x100	166091
SW 5x150	168703
SW 6x200	167817

Torx Screwdriver with Sliding Handle

985.730

	Ident-No.
T20x100	166092
T40x130	831404 o

Torx Screwdriver

985.730

	Ident-No.
T 7	167904
T8	166499
T9	164344
T15	163161

Torx-Offset Screw Driver

985.730

	Ident-No.
T15 for adjustment unit Altendorf	181147



Torx Screwdriver with Spinner Handle**985.730**

	Ident-No.
T9x60	173796
T15x80	171188
T15x140	179145

Screwdriver with Spinner Handle**985.730**

	Ident-No.
8 mm for spur	053874

Screwdriver with Wooden Handle**985.730**

	Ident-No.
9.0 mm (for hoggers)	011088

Adjusting and Depth Gauge**985.200**

	Ident-No.
0,3 mm	055883
0,7 mm	056096
1 mm	011103 o

Magnetic Stop**997.800**

	Ident-No.
0.0 mm	016613
0,5 mm	166093
1,0	166094
2-piece for glue joint cutter head	168152